



WALL COLLECTION

**GENERAL PRODUCT INFORMATION:**



This product is suitable for damp locations.

This product can mount either to a 4" square electrical box with a round plaster ring or an octagon electrical box.

This product can be dimmed with a standard incandescent dimmer.

This product may be mounted horizontally or vertically.

This instruction shows a typical installation.



**CAUTION — RISK OF FIRE**

This product requires installation by a qualified electrician. Before installing be sure to read all instructions and DISCONNECT POWER TO THE ELECTRICAL BOX.

**NOTE:** Due to the weight of this fixture, assistance will be needed for installation.

**Install the Fixture**

1A

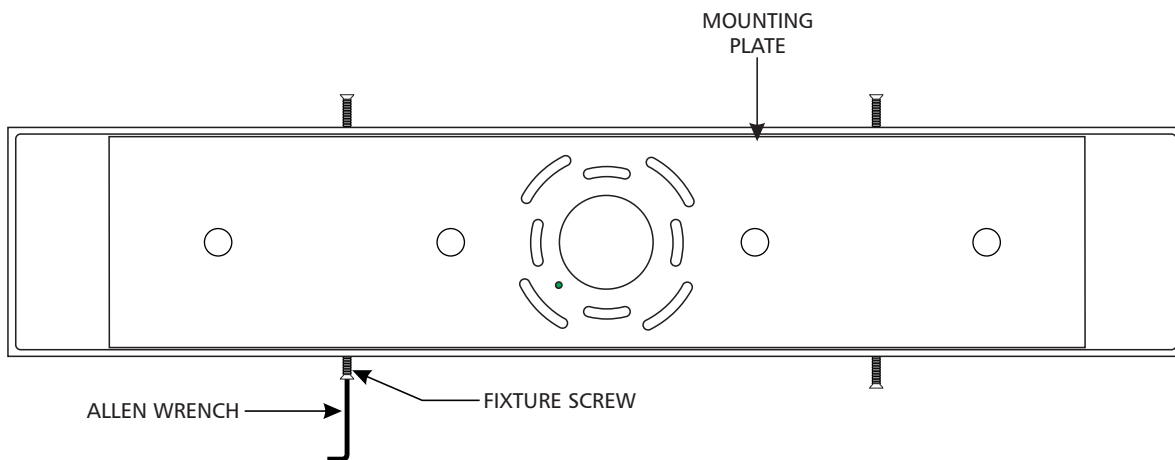

- 1 With the Allen wrench provided, unscrew and remove the four fixture screws.
- 2 Separate the mounting plate from the fixture.

1B

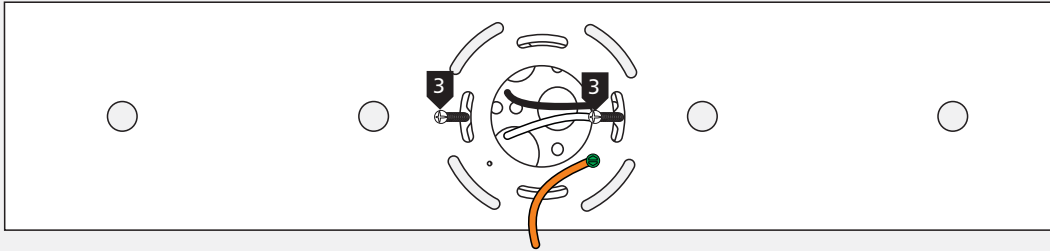

3 Level the mounting plate and secure it to the electrical box with the two #8-32 screws provided.

1C

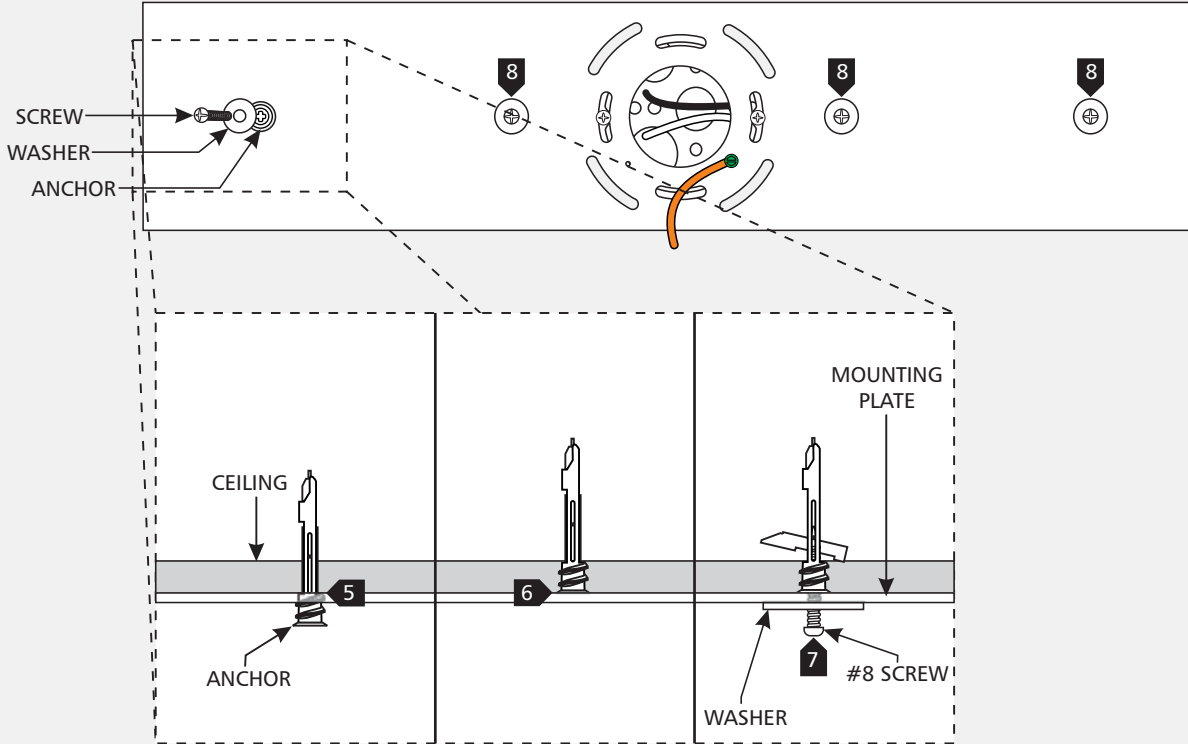

4 Verify that the mounting plate is level before continuing.

5 Line an anchor tip with the center of an anchor hole and hammer the anchor into the wall up to the threaded portion.

6 Screw the anchor in the rest of the way with a Phillips-head screwdriver.

7 Slide a #8 screw through a washer and screw it into the anchor to secure the mounting plate to the wall.

8 Repeat for the other anchor holes.

1D

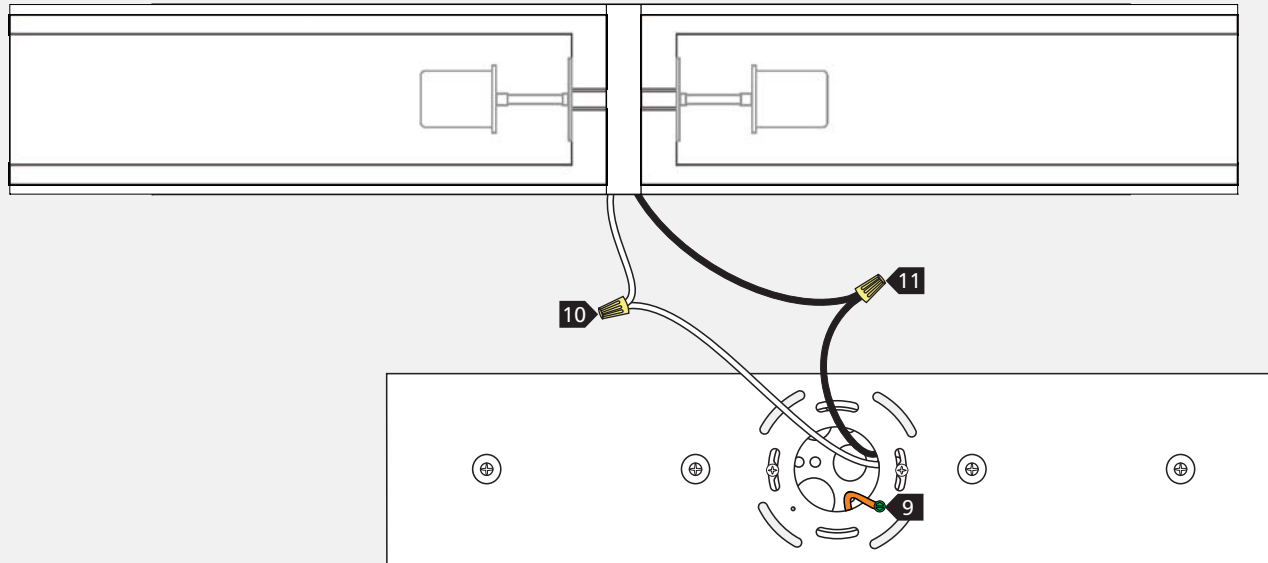

- 9 Connect the mounting plate ground wire to a suitable ground according to local electrical codes.
- 10 Connect the white fixture wire to the neutral power line wire with a wire nut.
- 11 Connect the black fixture wire to the hot power line wire with a wire nut.

1E

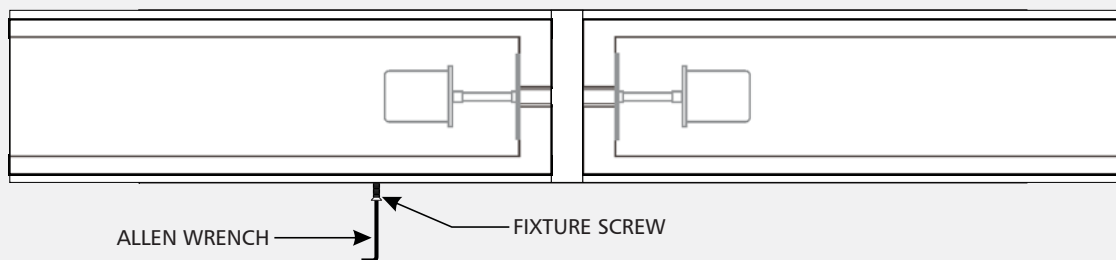

- 12 Properly place all wires and wire nut connections inside the electrical box.
- 13 Re-place the fixture onto the backplate and re-install the fixture screws.
- 14 Secure the fixture onto the mounting plate by tightening the fixture screws with the provided allen wrench.

# Install the Lamp and Diffuser

2A

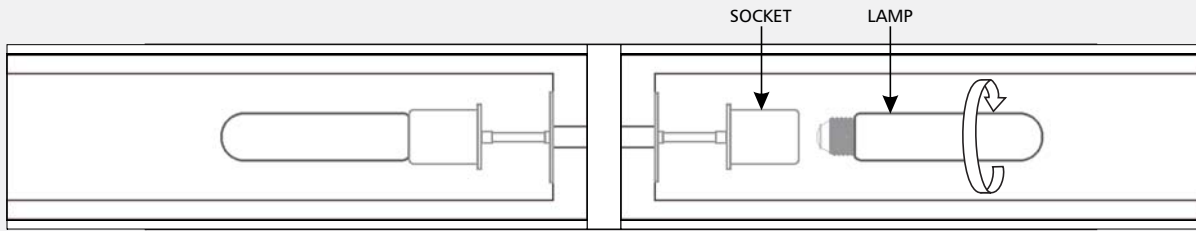

**CAUTION:** To reduce the risk of a burn or electric shock during relamping, disconnect the power to the fixture.

Use MAX 60 Watt Type T10 Medium Base Lamp.

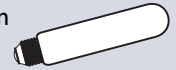

1 Screw the lamp into the socket.

2B

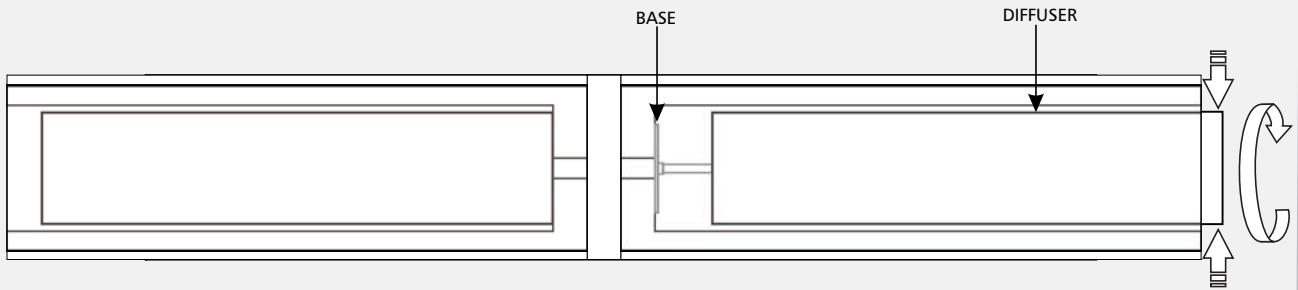

**CAUTION:** When installing the diffuser, apply even pressure on each side of the diffuser by using both hands to screw it in place. **DO NOT OVER TIGHTEN** the diffuser. This may break the glass resulting in injury.

**NOTE:** It is not necessary to remove the diffuser when replacing the lamp. If necessary, the diffuser may be removed to clean inside the outer glass.

2 Gently screw the diffuser onto it's base .

**SAVE THESE INSTRUCTIONS!**



**TECH LIGHTING®**

7400 Linder Ave, Skokie, IL 60077

847.410.4400

[www.techlighting.com](http://www.techlighting.com)

© 2012 Tech Lighting, L.L.C. All rights reserved. The "Tech Lighting" graphic is a registered trademark of Tech Lighting, L.L.C. Tech Lighting reserves the right to change specifications for product improvements without notification.

A Generation Brands Company