



**GENERAL PRODUCT INFORMATION:**



These fixtures are intended to be installed utilizing NEC compliant junction boxes.

This product is suitable for damp locations.

This product can be dimmed with a low-voltage electronic dimmer.

This instruction shows a typical installation.



**CAUTION - RISK OF FIRE**

This product must be installed in accordance with the applicable installation code by a person familiar with the construction and operation of the product and the hazards involved.

Use minimum 90°C supply conductors.

**Install the Fixture**

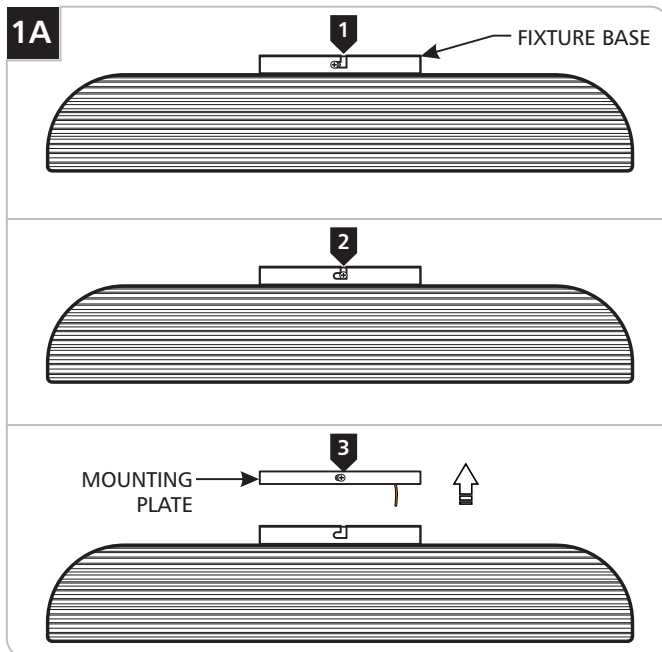

- 1 Back out (do not fully remove) the two screws on the fixture base.
- 2 Rotate the mounting plate counter clockwise to guide the screws to the open portion of the keyed slots.
- 3 Separate the mounting plate from the fixture base by pulling it out of the keyed slots.

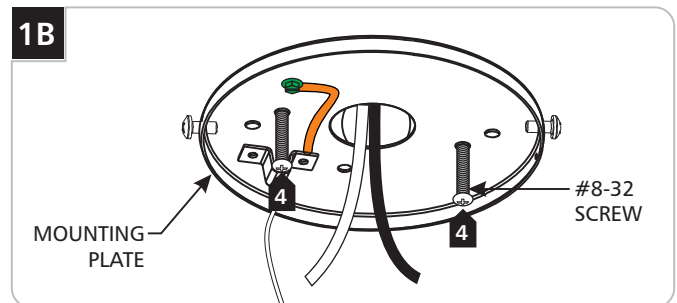

- 4 Mount the mounting plate to the electrical box with the two provided #8-32 screws.

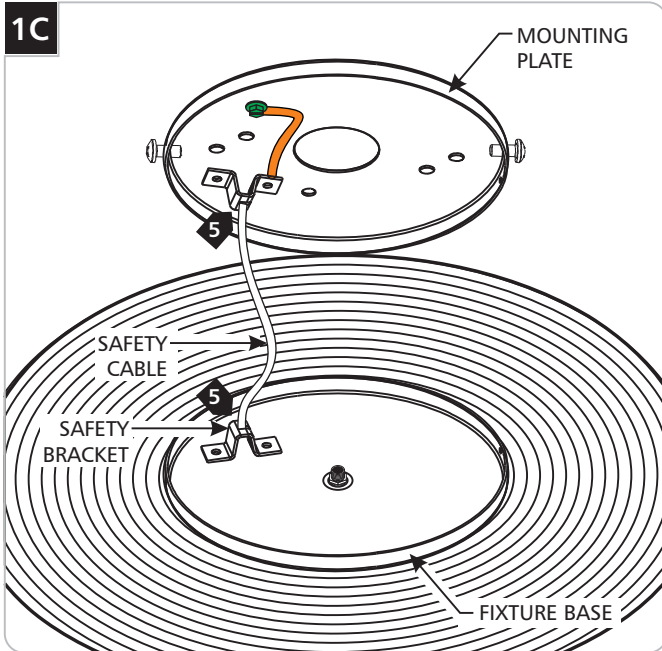

- 5** Hook a safety cable through the safety brackets on each end of the fixture base and mounting plate.

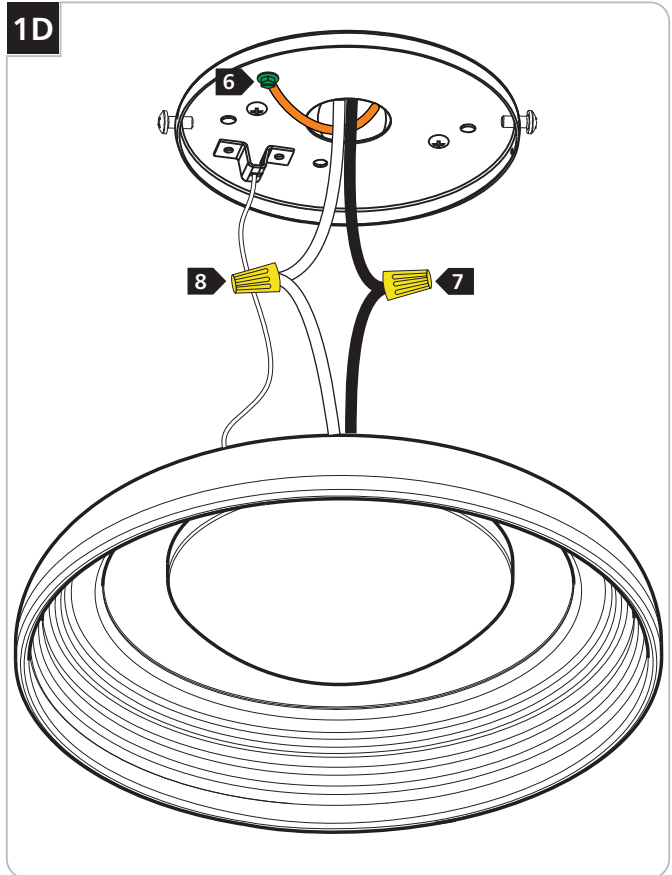

- 6** Connect the fixture to a suitable ground in accordance with local electrical codes.
- 7** Connect the black fixture wire to the hot power line wire with a wire nut.
- 8** Connect the white fixture wire to the neutral power line wire with a wire nut.
- 9** Neatly tuck the wires and wire nut connections into the electrical box and reinstall the fixture to the mounting plate (reversal of step 1A).

**SAVE THESE INSTRUCTIONS!**



**TECH LIGHTING®**

7400 Linder Ave, Skokie, IL 60077

847.410.4400

[www.techlighting.com](http://www.techlighting.com)

© 2015 Tech Lighting, L.L.C. All rights reserved. The "Tech Lighting" graphic is a registered trademark of Tech Lighting, L.L.C. Tech Lighting reserves the right to change specifications for product improvements without notification.

A Generation Brands Company